

PROPOSED CONSTRUCTION OF RESIDENTIAL BUILDING IN  
 PLOT NO. 23, SY NO. 60/2, AT THIRUMURUGAN NAGAR  
 EXTENSION EAST, OF VNO 20 TIRUNINRAVUR VILLAGE &  
 SELECTION GRADE TOWN PANCHAYAT LIMIT, POONAMALLEE  
 TALUK, TIRUVALLUR DISTRICT. SCALE 1:100

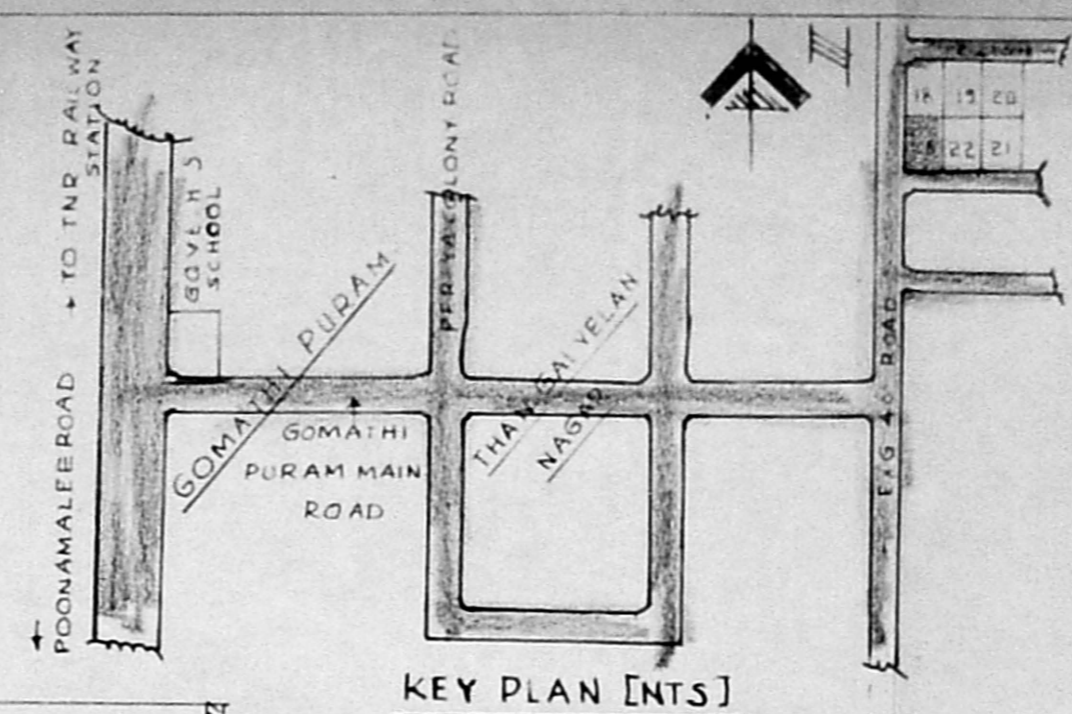

**AREA STATEMENT**

AREA OF SITE = 2576 SQ.FT. [260.75 SQ.M.]

PLINTH AREA OF PROPOSED BUILDING = 843 SQ.FT. [78.31 SQ.M.]

**PLANNING PARAMETERS PROVIDED**

PLOT EXTENT = 220.73 SQ.M.  
 PLOT COVERAGE = 33.5%  
 F.S.I. = 0.355  
 PLOT FRONTAGE = 10.98 M  
 HEIGHT OF BUILDING = 4.68 M  
 FRONT SET BACK = 1.52 M  
 SIDE SET BACK = 1.52 & 3.05 M  
 REAR SET BACK = 7.32 M  
 HEIGHT OF BASEMENT ABOVE THE GROUND LEVEL = 0.61 M  
 PASSAGE & ROAD WIDTH = 3.65 M & 12.2 M  
 SPLAY = 3.05 x 3.05 M  
 PARKING = NIL  
 INSTALLATION OF ELECTRIC MORTAR = NIL  
 LENGTH OF COMPOUND WALL = 204'

8/26/88/94/2000

Planning Permit No. **APPROVED**

SUBJECT TO THE CONDITIONS IN THIS OFFICE LETTER

No. 2987/2000 Date 28/08/88

FOR MEMBER SECRETARY ELEVATION  
 CHENNAI METROPOLITAN DEVELOPMENT AUTHORITY  
 CHENNAI - 600 008.

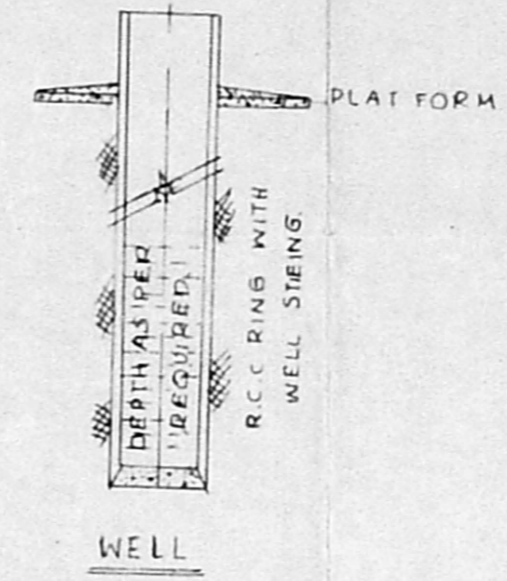
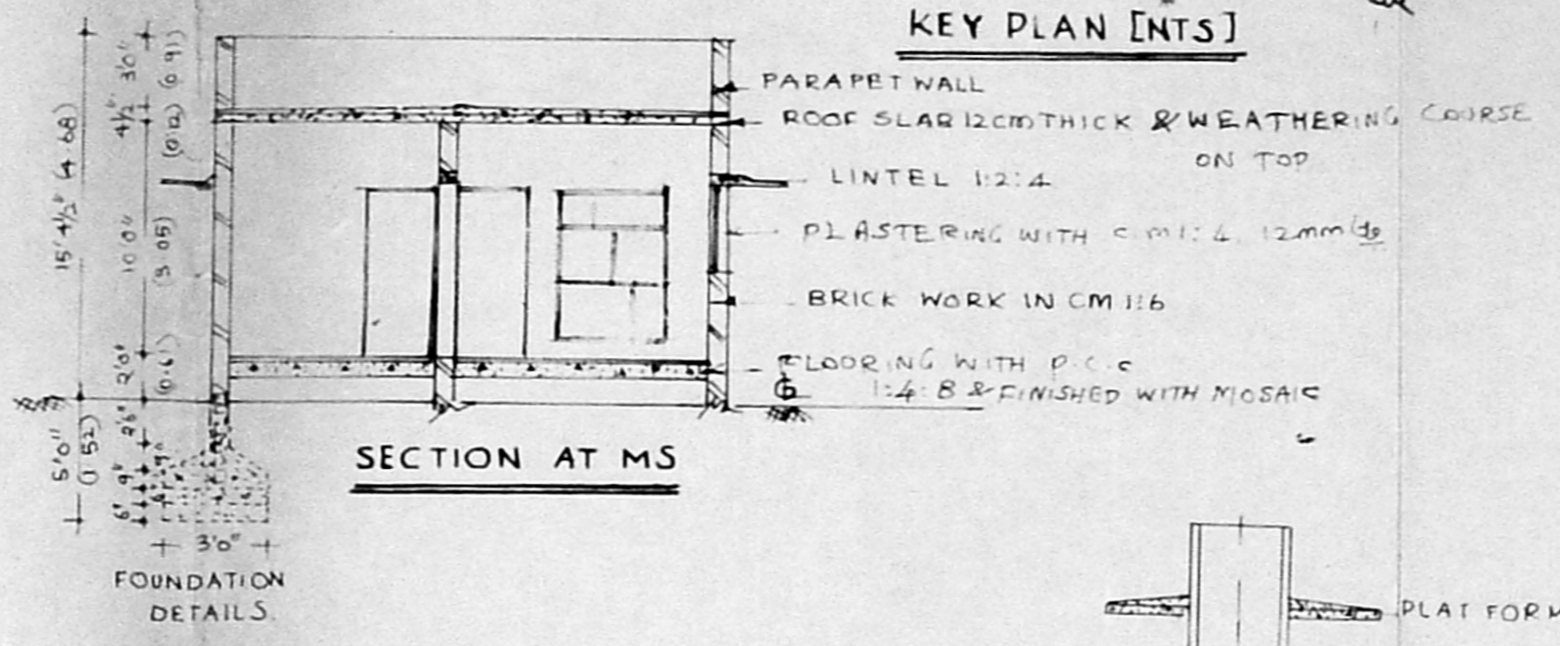

**SCHEDULE OF JOINERIES**

MAIN DOOR - 3'2" x 7'0"  
 D1 DOOR - 3'0" x 6'6"  
 D2 DOOR - 2'6" x 6'6"  
 W1 WINDOW - 5'0" x 4'0"  
 W2 WINDOW - 3'0" x 4'0"  
 W3 WINDOW - 4'0" x 2'0"  
 V - VENTILATOR - 2'0" x 1'6"

**LEGEND**

PROPOSAL SHOWN IN [Symbol]  
 EXISTING ROAD [Symbol]  
 BOUNDARY OF SITE [Symbol]

OWNER: [MR. P. SELVARAJ]

*K. Shanmuga Sundaram*  
**K. SHANMUGA SONDARAM, D.C.R.E.**  
 Civil Engineer & Builder,  
 Licensed Surveyor  
 Corporation of Chennai &  
 Tiruninravur Selection Grade,  
 TOWN PANCHAYAT  
 33, D.K.S. Complex, M.T.H. Road  
 TIRUNINRAVUR R.S.  
 CHENNAI - 602 020  
 LICENSED SURVEYOR

